



THE PARKSIDE SIG16763D



THE PARKSIDE SIG16763D Floor plan number: RUS071821AL

3 beds • 2 baths • 1216 sq.ft. • 16' width • 76' depth

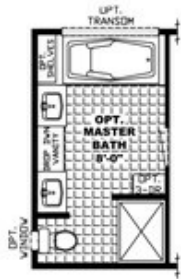
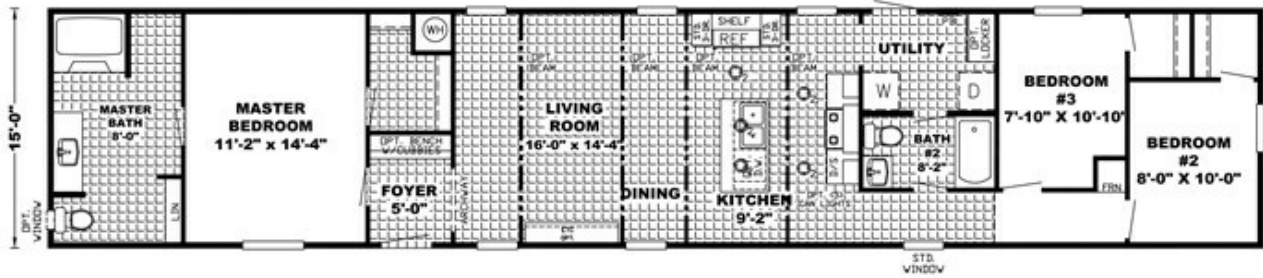

Our home building facilities invest in continuous product and process improvements. Plans, dimensions, features, materials, specifications and availability are subject to change without notice or obligation. Renderings and floor plans are representative likenesses of our homes and may differ from the actual homes. We invite you to tour a Home Center near you and inspect the highest value in quality housing available or call (225) 644-4663 to speak with a Home Consultant. Copyright 2017, CMH. All rights reserved.

CLAYTON HOMES-GONZALES

13653 AIRLINE HIGHWAY
 GONZALES, LA 70737

Monday - Thursday: 9am - 6pm
 Friday: 9pm - 6pm
 Saturday: 9am - 5pm
 Sunday: Closed

(225) 644-4663